

REVISIONS				
NO	DATE	DESCRIPTION	BY	CH
6	1-0-83	FOR PREVIOUS REV BLOCKS SEE RECORD MYLAR 8770-G-170 REV 7 FOR PREVIOUS REV BLOCKS SEE RECORD MYLAR 8770-G-170 REV 7 ADD (C-3) ELEVATION PC/M 43-73 REV (G-14) PIPING PC/M 105-80 REV (E-7X-D-10) LINE W/B ADD (D-7) TANKS & PUMPS PC/M 118-80 ADD (K-2) GAS DISPENSER PC/M 72-81 ADD (G-13) PIPING GENERAL REV (C-15) PIPING (E-14) VA U/B (F-19) NOTES ADD: (C-12 & 14) PIPING	AA	PD
9	5/16/84	ADD (K-15) (F-10) (K-15, 14) PIPING (S&B) F APP'D BY R.C. ROSSI RE # 0032763	MAC	PD

- NOTES:
- ALL PIPING SHALL CONFORM TO PIPING LINE LIST DRAWING 8770-B-052 & SPEC FLO-8770-099.
 - NO ALLOWANCE HAS BEEN MADE FOR THE WELDS OR GASKETS.
 - ELBOWS INDICATED BY SHARP CORNERS SHALL BE OF LONG RADIUS TYPE, UNLESS OTHERWISE NOTED.
 - FOR SMALL BRANCH PIPE CONNECTIONS, SEE DESIGN GUIDES M4-20 & M4-21.
 - CONSTRUCTION SHALL LOCATE & SET ALL PIPE SLEEVES IN CONCRETE FLOORS AND WALLS BEFORE CONCRETE IS PLACED. SEE CIVIL DRAWINGS FOR TYPICAL DETAILS OF PIPE SLEEVES & FOR OPENINGS REQUIRING SPECIAL FRAMING.
 - OPENINGS 8 INCHES IN DIAMETER & LARGER, IN GRATING & CHECKERED PLATE FLOORS FOR SHOP FABRICATED PIPING SHALL BE PROVIDED BY STRUCTURAL STEEL FABRICATOR. ALL OTHER OPENINGS IN GRATING & CHECKERED FLOOR PLATES SHALL BE PROVIDED IN THE FIELD.
 - DESIGN & LOCATION OF PIPE SUPPORTS, ANCHORS & RESTRAINTS TO BE BY EBASCO.
 - DESIGN OF THRUST BLOCKS BY CIVIL DEPT.
 - CONSTRUCTION TO PROVIDE CONCRETE APRONS FOR ALL LINES ENTERING INTAKE AND DISCHARGE CANALS.
 - FOR BURIED PIPING 14 INCH IN DIA. & LARGER, USE ANSI A21.1, LAYING CONDITION B. FOR BURIED PIPING 12 INCH IN DIA. & SMALLER USE ANSI A21.1, LAYING CONDITION A.
 - DETAILING OF NON-WELDED PIPING SHOWN ON THIS DRAWING TO BE BY CONSTRUCTION ENGINEERING. DETAILING OF WELDED PIPING SHOWN ON THIS DRAWING TO BE BY EBASCO.
 - ALL OPENINGS SHALL CONSIDER CLEARANCE REQUIREMENTS DUE TO THERMAL GROWTH, SEISMIC MOVEMENTS & DIFFERENTIAL SETTLEMENT OF STRUCTURES.

- LEGEND:
- INSULATING FLANGE PER EBASCO DWG A-95358
 - FH - DENOTES FIRE HYDRANT
 - AREA THAT PIPING IS SHOWN ON OTHER DWGS

REFERENCE DRAWINGS:

LIST OF DRAWINGS	8770-A-146
VALVE & SPECIALTY LIST	8770-A-051
LINE LIST	8770-B-052
INST SYMBOLS	8770-B-270
FLOW DIAG-FEEDWATER, CONDENSATE & AIR EVACUATION SYSTEM	8770-G-080
FLOW DIAG-CIRCULATING & INTAKE COOLING WATER SYSTEM	8770-G-082
FLOW DIAG-COMPONENT COOLING SYS	8770-G-083
FLOW DIAG-FIRE, WATER, DOMESTIC & MAKEUP SYSTEM	8770-G-084
FLOW DIAG-SERVICE & INST AIR SYS	8770-G-085
FLOW DIAG-MISCELLANEOUS SYSTEM	8770-G-086
FLOW DIAG-CONTAINMENT SPRAY & REFUELING WATER SYSTEM	8770-G-088
FLOW DIAG-MISC SYS - SH 3	8770-G-093
SGBF YARD PIPING	3509-G-140
SH 1	
SGBF YARD PIPING	3509-G-140
SH 2	
YARD PIPING, SH 1B	8770-G-170
SH 2	
YARD PIPING, SH 1C	8770-G-170
SH 3	

THE DESIGN INFORMATION FOR THE CHANGES SHOWN IN THIS REVISION HAS BEEN ENGINEERED BY FLORIDA POWER & LIGHT COMPANY.

THIS DOCUMENT IS THE PROPERTY OF EBASCO SERVICES INCORPORATED. ITS USE IS EXPRESSLY RESTRICTED BY THE TERMS OF THE CONTRACT, DATED AS OF AUGUST 10, 1988 BETWEEN EBASCO SERVICES INCORPORATED AND FLORIDA POWER & LIGHT COMPANY.

FLORIDA POWER & LIGHT COMPANY
ST. LUCIE PLANT
1976-890,000 KW INSTALLATION UNIT NO 1

YARD PIPING SHEET NO 1A

EBASCO SERVICES INCORPORATED

SCALE 1"=20'-0"

APPROVED DATE 6-20-83

DR MECH [Signature] 8770-G-170

DR ANDERSON [Signature] SHEET 1

CH P. GAGAN

REGULATORY DOCKET FILE COPY



Docket # 50-326
Control # 8703060021
Date 05-22-77 of Document
REGULATORY DOCKET FILE

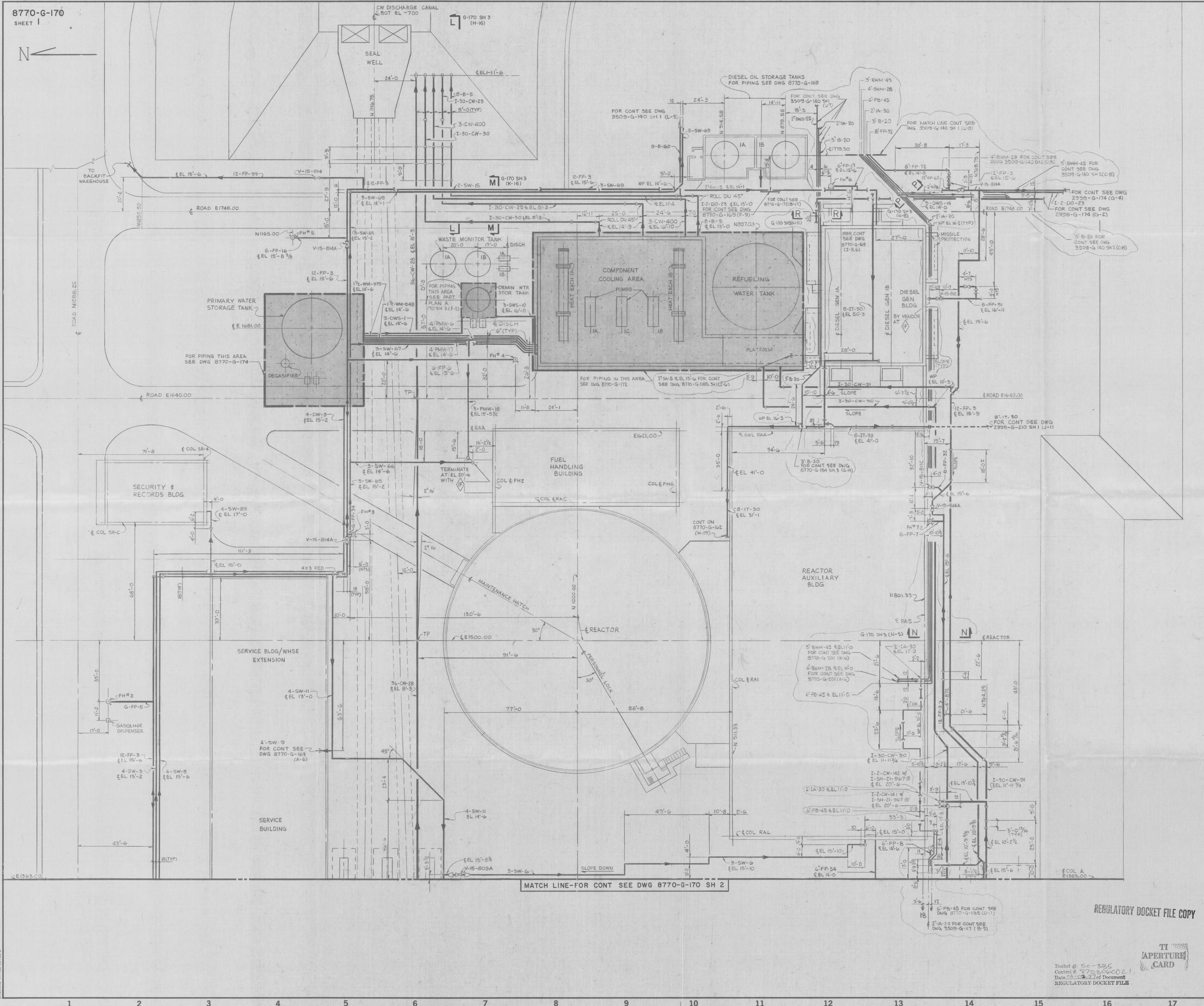

MATCH LINE-FOR CONT SEE DWG 8770-G-170 SH 2

DRAWING 44132-50108-B

8703060033