

- NOTES:**
1. THE FOLLOWING ARE THE COORDINATES FOR NEW PLANT SITE CENTER:  
 NEW JERSEY STATE PLAN (NAD83)  
 NORTHING: 234,753,998.5  
 EASTING: 188,529,293.8  
 GEOGRAPHIC (NAD83)  
 LATITUDE: 39° 28' 23.7436"  
 LONGITUDE: 75° 39' 24.3316"  
 UNIVERSAL TRANSVERSE MERCATOR (NAD83 ZONE 18)  
 NORTHING: 14,335,392,324  
 EASTING: 148,800,710"  
 U.S. NATIONAL GRID (NAD83)  
 USNG: 18SVJ5354569436  
 PLANT GRID COORDINATES  
 N3532.538"  
 W880.686"
  2. TEMPORARY CONSTRUCTION IMPACT DUE TO INSTALLATION OF TRANSMISSION TOWERS IN THIS AREA (APPROXIMATELY 5 ACRES).
  3. AREAS DESIGNATED AS "TEMPORARY CONSTRUCTION AREA" WILL INCLUDE CONSTRUCTION SUPPORT FACILITIES INCLUDING PARKING, CONSTRUCTION OFFICES, CONSTRUCTION FABRICATION AND SERVICES FACILITIES, LAYDOWN STORAGE, AND OTHER FACILITIES / FEATURES NECESSARY FOR CONSTRUCTION OF THE PROPOSED FACILITY.
  4. PERMANENT IMPACT DUE TO INSTALLATION OF BARGE MOORING CAISSONS, LESS THAN 1 ACRE IMPACT.

**LEGEND**

- PERMANENT PLANT USE AREA
- TEMPORARY CONSTRUCTION USE AREA
- New TLD
- Existing TLD

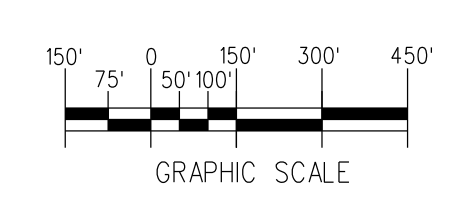
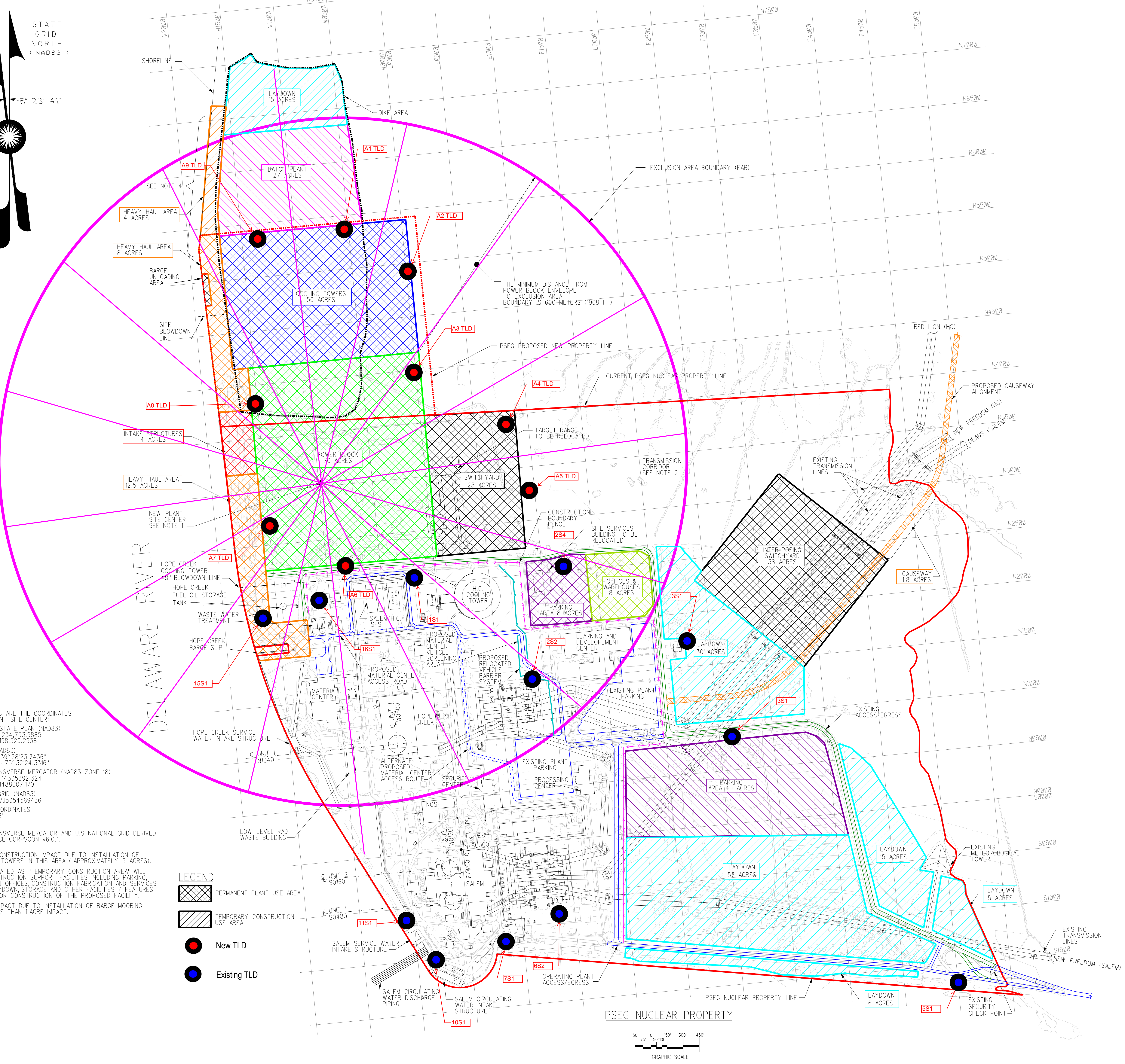

**PSEG Power, LLC  
PSEG Site ESPA  
Part 3, Environmental Report**

**New Sample Locations  
FIGURE 6.2-3  
Rev. 0**