

- LEGEND:**
- RADIUM-226 10-FT CONTOUR
  - × 11.8 SPOT/POINT DATA
  - ⊕ 94 TMW WELL
  - PWW-2 POTABLE WATER WELL
  - SYNTHETIC LINER CURTAIN BACKED BY GEOGRID
  - Kminus3 NATURALLY OCCURRING RADIOACTIVE MATERIAL (NORM) AREA
  - TS NATURALLY OCCURRING RADIOACTIVE MATERIAL (NORM) AREA

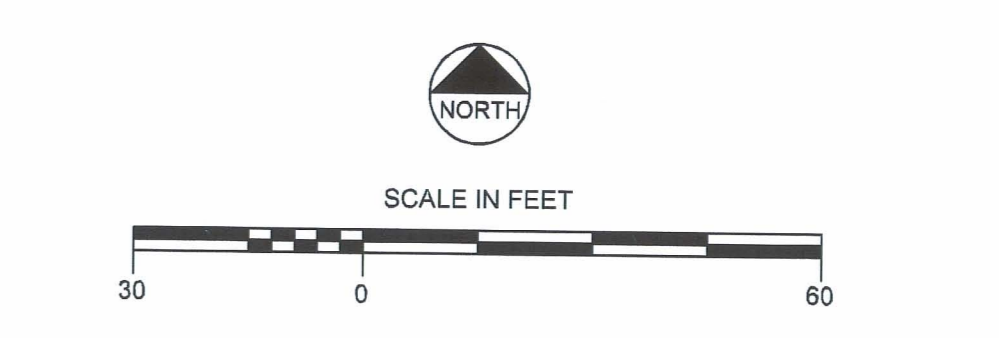

<p>PROJECT NO: 180889 (06-442)</p> <p>DATE: MARCH 2008</p> <p>DESIGNED BY:</p> <p>DRAWN BY: MCL</p> <p>CHECKED BY: OSCAR PAULSON</p> <p>APPROVED BY:</p>	<p>PREPARED BY:</p>
<p><b>SWEETWATER URANIUM PROJECT</b></p> <p><b>CATCHMENT BASIN EXCAVATION</b></p> <p><b>RADIUM-226 FINAL RESULTS</b></p> <p><b>CONTOURS</b></p>	
<p>PREPARED FOR:</p>	<p>DRAWING NO:</p>

C:\Users\mcl\Documents\180889\180889.dwg 3/10/08 10:07:27 AM 11/11/2008