

SECTION OF FENCE REMOVED WHEN K3-MINUS 3 AREA WAS EXCAVATED  
 APPROXIMATE TEMPORARY FENCE DURING EXCAVATION

88 & 89  
 HIGH VOLUME  
 AIR SAMPLING  
 LOCATION

- LEGEND:**
- +16.2 COMPOSITE DATA
  - x 11.8 SPOTPOINT DATA
  - ⊕ 94 TMW WELL
  - PWW-2 POTABLE WATER WELL
  - SYNTHETIC LINER CURTAIN BACKED BY GEOGRID
  - Kminus3 NATURALLY OCCURRING RADIOACTIVE MATERIAL (NORM) AREA
  - T5 NATURALLY OCCURRING RADIOACTIVE MATERIAL (NORM) AREA

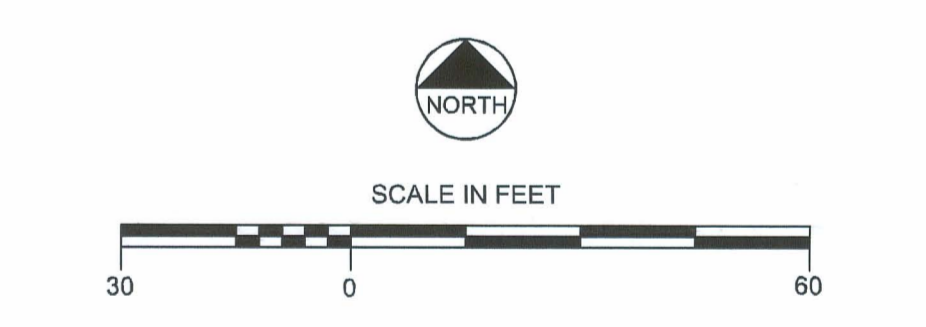

PROJECT NO:	180899 (06-442)	PREPARED BY:	
DATE:	APRIL 2008		
DESIGNED BY:			
DRAWN BY:	MCL		
CHECKED BY:	OSCAR PAULSON		
APPROVED BY:			

**SWEETWATER URANIUM PROJECT  
 CATCHMENT BASIN EXCAVATION  
 TOTAL EXTRACTABLE HYDROCARBONS  
 (milligrams per kilogram)**

PREPARED FOR:		DRAWING NO.:	
---------------	--	--------------	--

D-06