

842500 survey ftE 845000 survey ftE 847500 survey ftE 850000 survey ftE 852500 survey ftE 855000 survey ftE

1155000 survey ftN 1152500 survey ftN 1150000 survey ftN 1147500 survey ftN 1145000 survey ftN 1142500 survey ftN 1140000 survey ftN 1137500 survey ftN 1135000 survey ftN

R 7 6 W

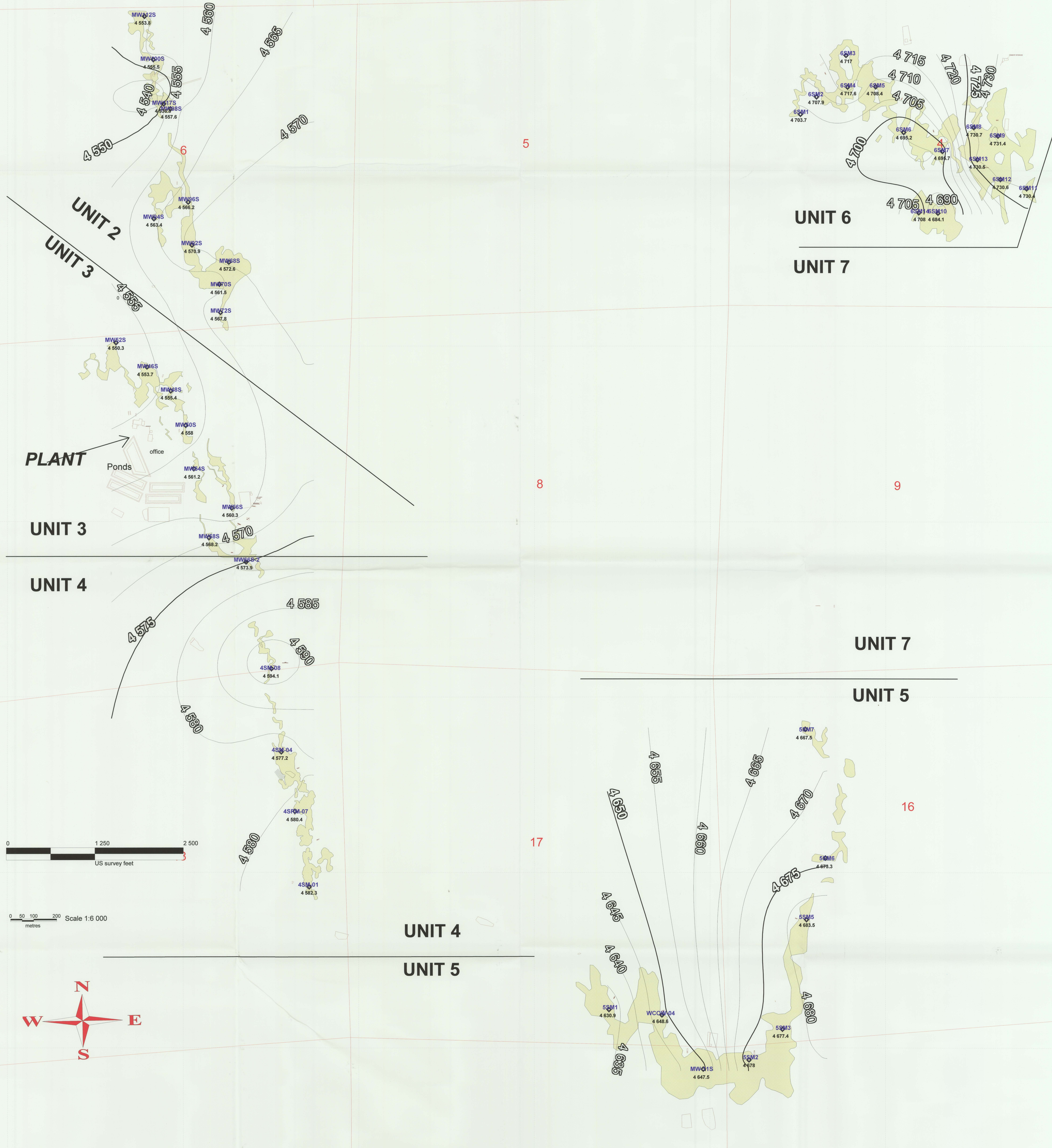

PLANT
office
Ponds

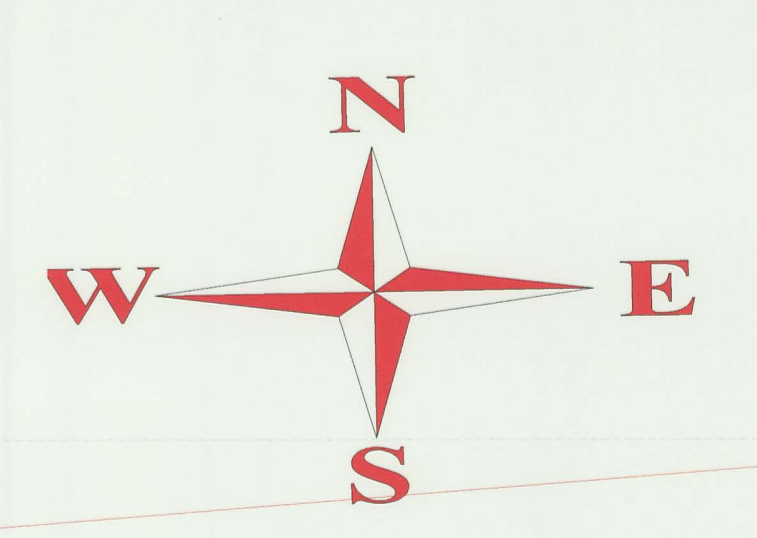
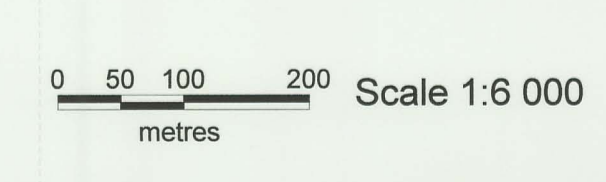
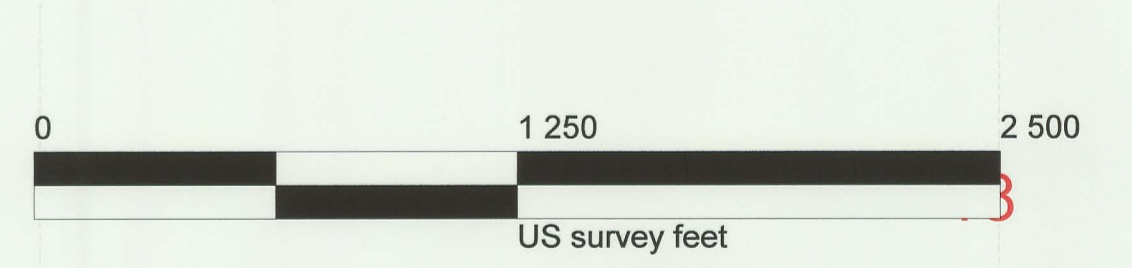

COGEMA Mining, Inc.
Christensen Project

SHALLOW ZONE PIEZOMETRIC MAP
MINE UNITS 2 THRU 6
PERMIT TO MINE NO. 478
PIEZOMETRIC LEVELS TAKE JUNE 2007

Environmental: L. Arbogast	Slate: Wyoming County: Johnson
Geology: S. Bottero	Scale: 1:6000
Drafting: S. Bottero	Drawing ID:
Date: 06/29/2007	Projection: Wyoming 4902, East Central Zone (1927)
Revision:	

- LEGEND**
- ◊ 4SM-04 hole_id
 - ◊ 4730.5 water elevation
 - iso-piezometric contour (25 feet)
 - iso-piezometric contours (5 feet)
 - ▭ Christensen Ranch Permit Boundary

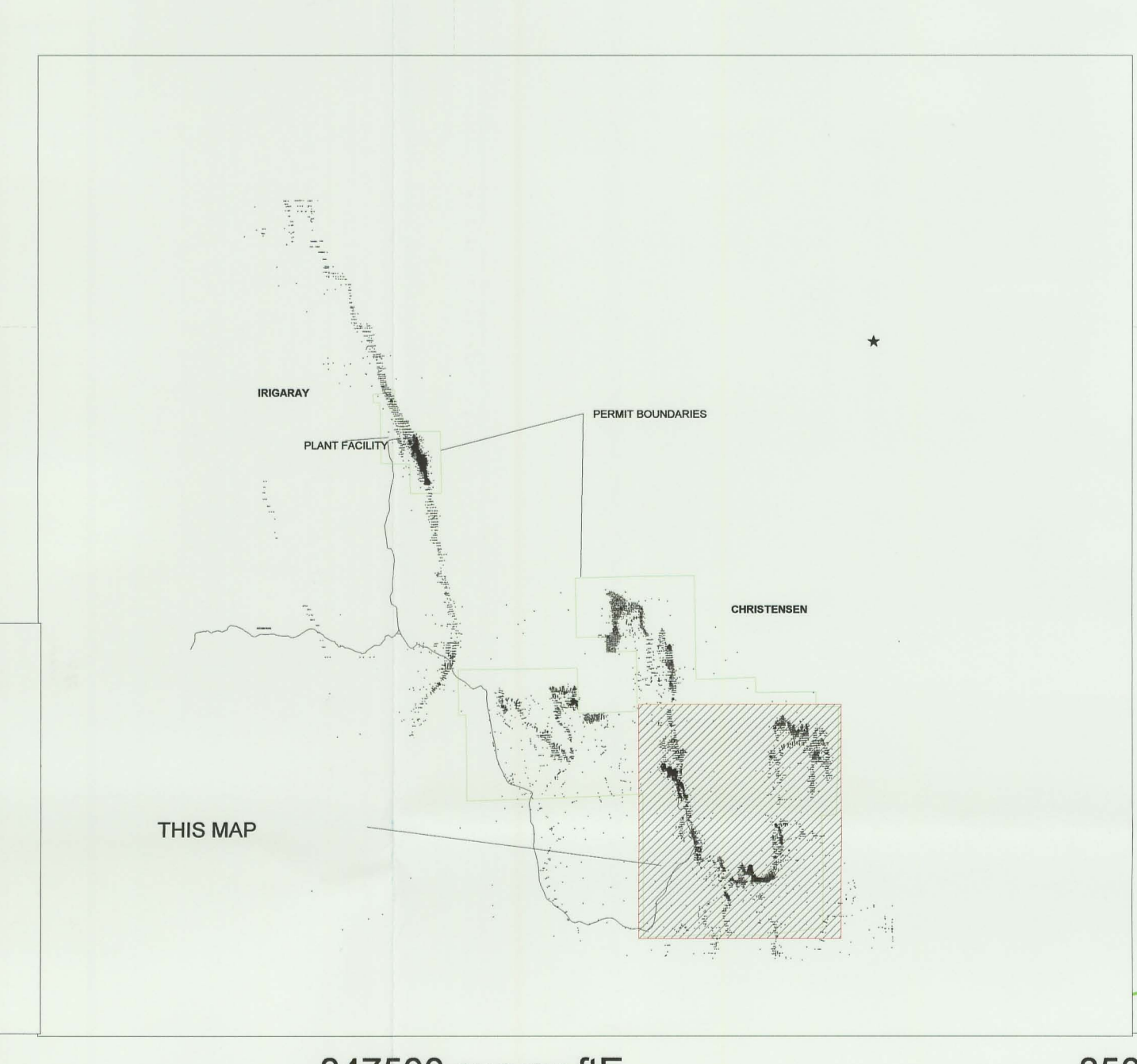

842500 survey ftE 845000 survey ftE 847500 survey ftE 850000 survey ftE 852500 survey ftE