

842500 survey ftE 845000 survey ftE 847500 survey ftE 850000 survey ftE 852500 survey ftE 855000 survey ftE

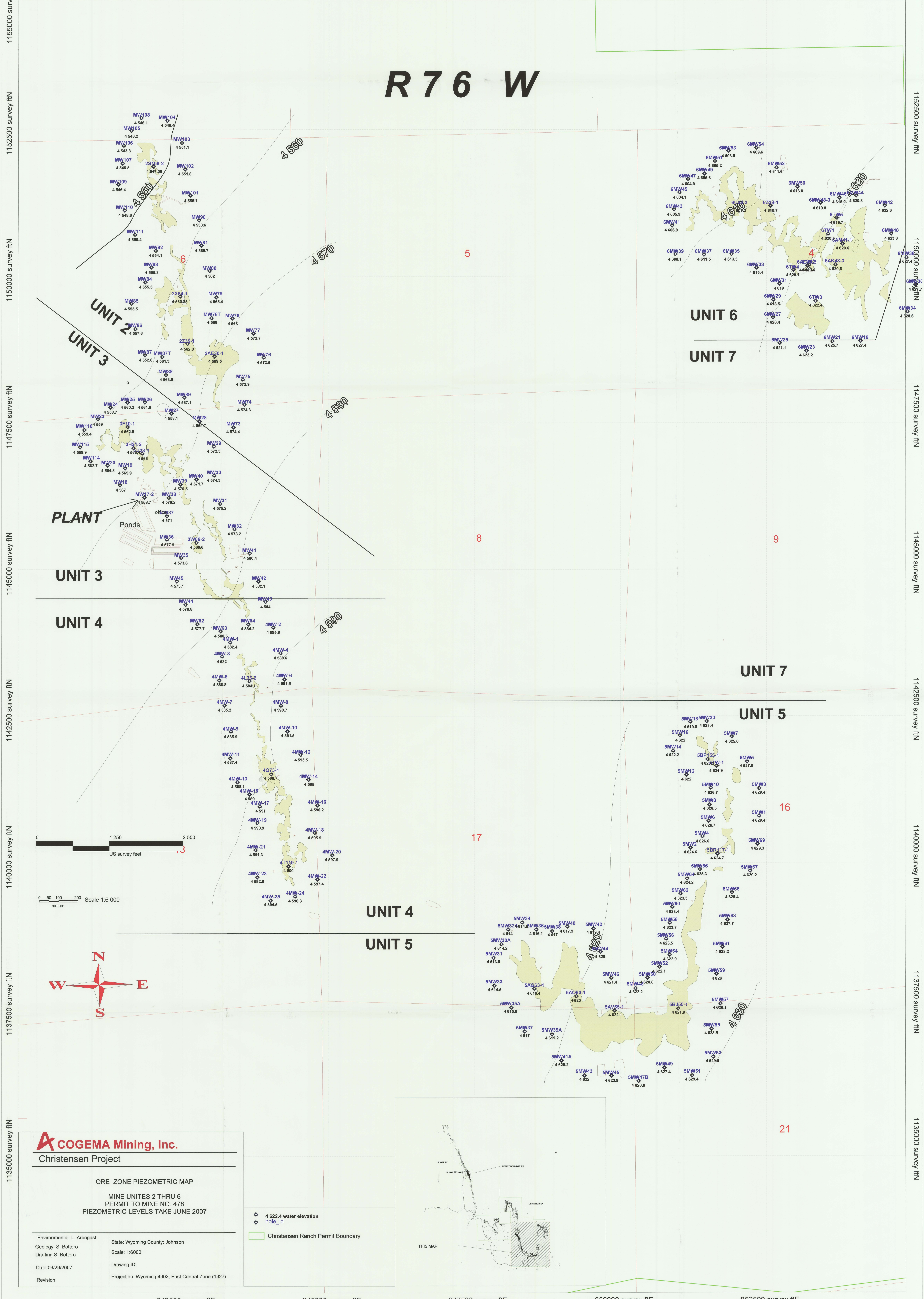

R 76 W

PLANT
Ponds

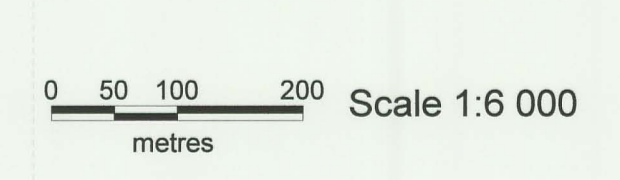
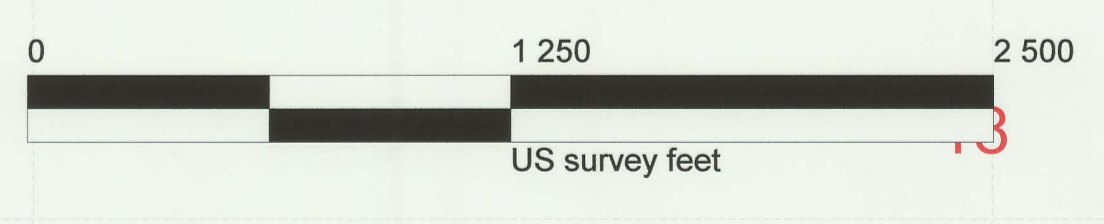

COGEMA Mining, Inc.
Christensen Project

ORE ZONE PIEZOMETRIC MAP
MINE UNITS 2 THRU 8
PERMIT TO MINE NO. 478
PIEZOMETRIC LEVELS TAKE JUNE 2007

Environmental: L. Arbogast	State: Wyoming County: Johnson
Geology: S. Bottero	Scale: 1:6000
Drafting: S. Bottero	Drawing ID:
Date: 06/29/2007	Projection: Wyoming 4902, East Central Zone (1927)
Revision:	

- ◆ 4 622.4 water elevation
- ◆ hole_id
- Christensen Ranch Permit Boundary

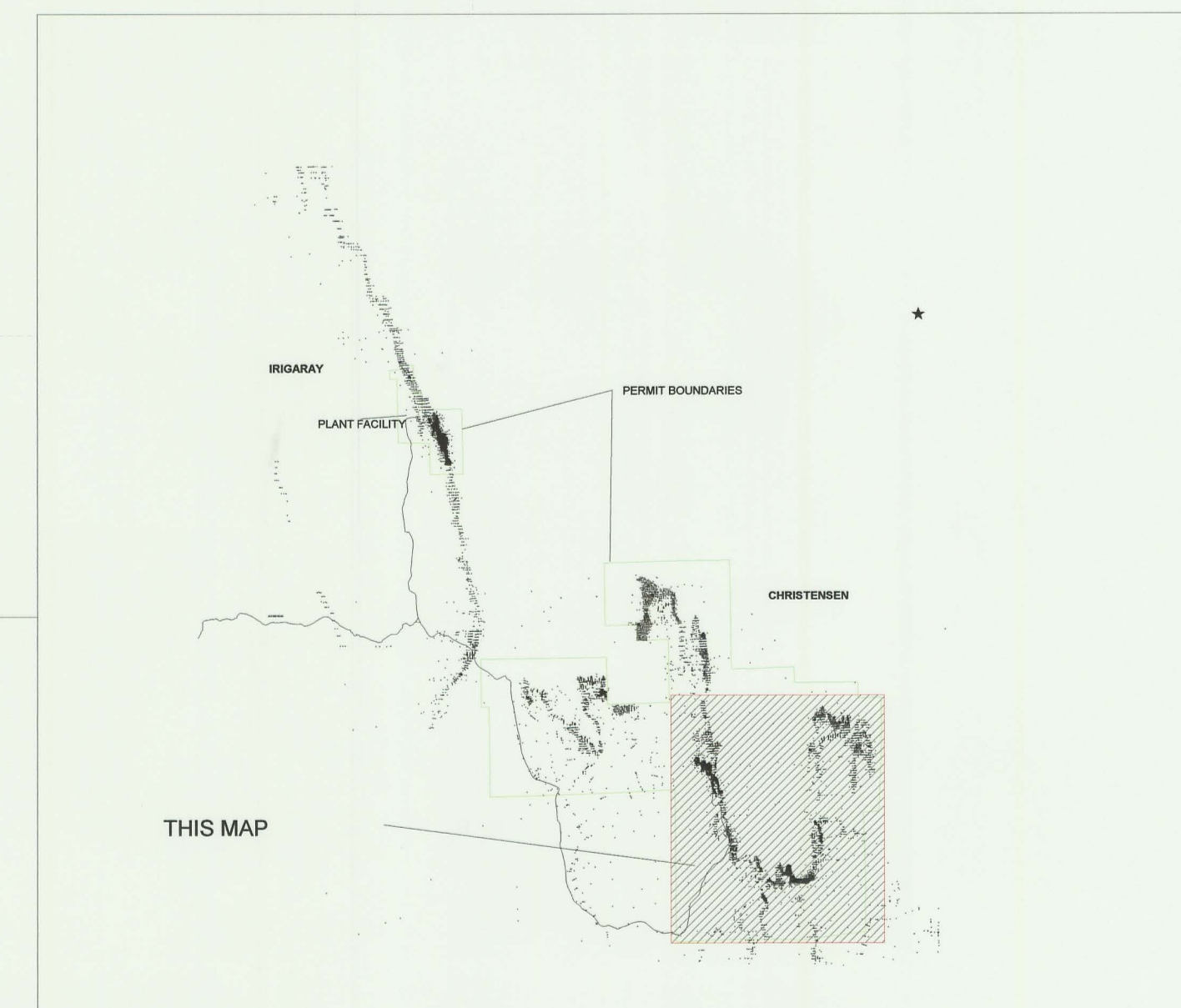

842500 survey ftE 845000 survey ftE 847500 survey ftE 850000 survey ftE 852500 survey ftE 855000 survey ftE