

**Regional Cardiology
Associates, P.L.C.**
3399 Pollock Road
Grand Blanc, MI 48439

Fax

u.s. Nuclear Regulatory Comm.
To: Bill Reichhold From: Linda Sanders/KE
Fax: 1-630-515-1078 Pages: 5
Phone: _____ Date: 06-15-07
Re: Survey of Facility for License # 21-32298-01
Regional Cardiology, 2486 Nerredia, Ste E, Flint, Mi 48532

● The document(s) in this facsimile transmission may contain confidential health information that is privileged and legally protected by the Health Insurance Portability and Accountability Act of 1996 (HIPPA). This information is intended only for the use of the individual or entity named above. If you are not the intended recipient, you are hereby notified that reading, disseminating, disclosing, distributing, copying or acting upon or otherwise using the information contained in this facsimile is strictly prohibited. If you have received this information in error, please notify the sender immediately at the number indicated below or return the original message to our office at the address indicated below.

- Billing Department 810-579-1701, Fax: 810-579-1705
- Medical Records Department 810-603-0170, Fax: 810-603-2370
- Reception Department 810-603-0170, Fax: 810-579-2578
- Scheduling Department 810-603-0170, Fax: 810-579-0283

Toll Free Office Number: 1-800-882-2012

◆ If there are any problems detected with either the number of pages received or the quality of the transmission, please call our office at the number indicated above.

Radiological Physics Service, Inc.

• 3839 Napier Road – Plymouth, Michigan 48170 • (734) 455-4730 • fax: (734) 453-8851

March 19, 2007

U. S. NUCLEAR REGULATORY COMMISSION
Region III
Materials Licensing Branch
2443 Warrenville Road, Ste 210
Lisle, IL 60532-4352

RE: Survey of Facility for License #21-32298-01, Regional Cardiology, 2486 Nerredia, Ste E, Flint, MI 48532

The decommission survey of the Regional Cardiology, 2486 Nerredia, Ste E, Flint, MI 48532-4807 location under license #21-32298-01 was performed on March 19, 2007.

The results of the survey are: All surveys and wipes tests prove to be below background measurements. The following methodology was performed:

1. A comprehensive survey of the entire Nuclear Hot Lab, and all stress lab room and imaging Gamma Camera areas, were performed using a GM end window survey meters. Surveys were performed at the most sensitive setting. All survey results proved to be below background measurements. (Survey locations are indicated on attached map). The following meter was used:
 - a. Ludlum GM Model 14C – Recently Calibrated (8/3/06)
2. Wipe tests were performed on twenty-two (22) locations (indicated on attached map). Wipe tests were counted in a Capintec CRC-15W well, for 1 minute.

Window 0-600keV

Hot Lab

1. Countertop at Dose Drawing Area
2. Background – outside of lab in hallway
3. Dose Drawing area floor
4. Hot Lab Waste Storage undercabinet area
5. Entrance to Hot Lab at door
6. Countertop at door end
7. Closet in Hot Lab
8. Stress Lab (downstairs) Entrance
9. Patient table (1) in Stress Lab
10. Patient table (2) in Stress Lab
11. Patient floor area (1) in Stress Lab
12. Patient floor area (2) in Stress Lab
13. Imaging room Gamma table (1) Downstairs

14. Imaging room floor (1) downstairs
15. Imaging room Gamma table (2) downstairs
16. Imaging room floor (2) downstairs
17. Stress treadmill area upstairs
18. Stress area floor upstairs
19. Imaging room upstairs camera area
20. Imaging room upstairs on floor near camera area
21. Control panel of upstairs imaging room equipment
22. Control panel of downstairs imaging room equipment

All wipes were below 2000 dpm. All wipe areas were also surveyed with the GM survey meter and all areas recorded less than 0.03 mR/hr.

All Sealed sources were leak tested. All leak testing was background prior to and after transport.

If there are any further questions please contact survey nuclear medical physicist Laura T. Smith, MS at (586) 215-5947 or pager 313 609-2038.

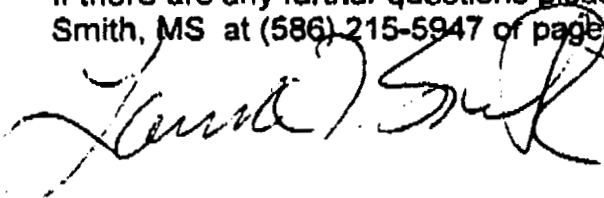

Randa Sanchez
Business Manager
Regional Cardiology

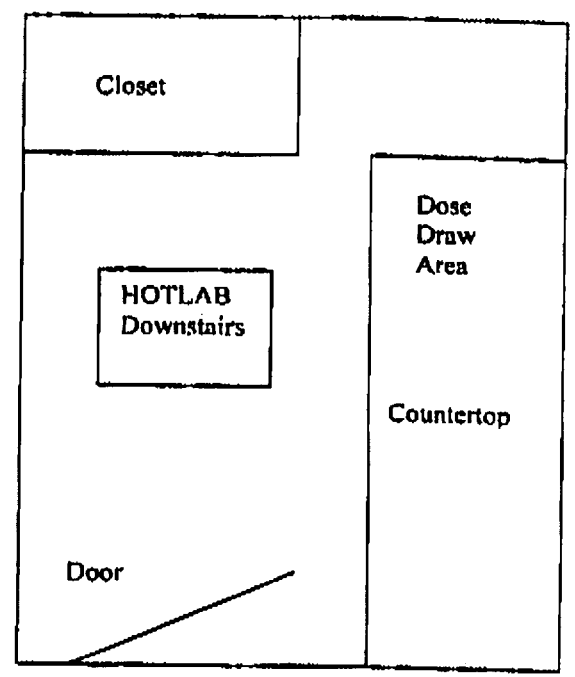

Hallway

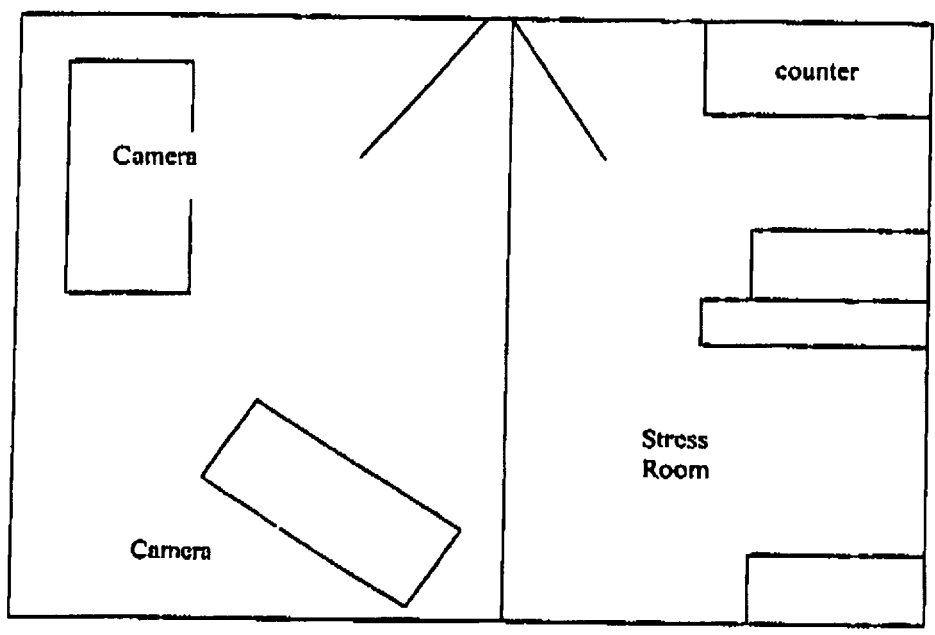

License #21-32298-01, Regional Cardiology, 2486 Nerredia, Ste E, Flint, MI 48532
3/19/2007

