



REGIONAL CARDIOLOGY ASSOCIATES, P.L.C.

Radwan Alkiek, M.D., F.A.C.C.
Omar Bakr, M.D., F.A.C.C.
Hameem Changezi, M.D., F.A.C.C.
David Dobies, M.D., F.A.C.C., F.S.C.A.I.
Vuong DuThinh, M.D., Ph.D., F.A.C.P., F.A.C.C.
Imad Issawi, M.D., F.A.C.C.
James Kure, M.D., F.A.C.C.
Paul Lafia, M.D., F.A.C.C.
Jeffrey Ledis, D.O., F.A.C.C.
Ramesh Misra, M.D., F.A.C.C.
Abdulfatah Osman, M.D., F.A.C.C., F.S.C.A.I.
Gary Weber, D.O., F.A.C.C.

March 19, 2007

U.S. Nuclear Regulatory Commission
Region III
Materials Licensing Branch
2443 Warrenville Road, Ste 210
Lisle, IL 60532-4352

RE: Amendment for License #21-32298-01

Please note we have decommissioned our site at location 2486 Nerredia, Ste E, Flint, MI 48532-4807 (see attached). We wish to amend our license to remove that location from our license.

We have successfully moved to our approved 3399 Pollock Rd., Grand Blanc, MI location.

If there are any further questions please contact our nuclear medical physicist Laura T. Smith, MS at (586) 215-5947 or pager (313) 609-2038.

Sincerely,

Hameem Changezi, M.D., F.A.C.C.
Authorized User

Grand Blanc

3399 Pollock Road
Grand Blanc, MI 48439
Phone: (810) 603-0170
Fax: (810) 603-2370

Clarkston

5625 Water Tower Place, Suite 270
Clarkston, MI 48346
Phone: (248) 620-4270
Fax: (248) 620-4272

Lapeer

944 Baldwin Road, Suite B
Lapeer, MI 48446-3089
Phone: (810) 603-0170
Fax: (810) 245-3833

RECEIVED MAY 14 2007

Radiological Physics Service, Inc.

• 3839 Napier Road – Plymouth, Michigan 48170 • (734) 455-4730 • fax: (734) 453-8851

March 19, 2007

U. S. NUCLEAR REGULATORY COMMISSION

Region III

Materials Licensing Branch

2443 Warrenville Road, Ste 210

Lisle, IL 60532-4352

RE: Survey of Facility for License #21-32298-01, Regional Cardiology, 2486 Nerredia, Ste E, Flint, MI 48532

The decommission survey of the Regional Cardiology, 2486 Nerredia, Ste E, Flint, MI 48532-4807 location under license #21-32298-01 was performed on March 19, 2007.

The results of the survey are: All surveys and wipes tests prove to be below background measurements. The following methodology was performed:

- 1. A comprehensive survey of the entire Nuclear Hot Lab, and all stress lab room and imaging Gamma Camera areas, were performed using a GM end window survey meters. Surveys were performed at the most sensitive setting. All survey results proved to be below background measurements. (Survey locations are indicated on attached map). The following meter was used:
 - a. Ludlum GM Model 14C – Recently Calibrated****
- 2. Wipe tests were performed on twenty-two (22) locations (indicated on attached map). Wipe tests were counted in a Capintec CRC-15W well, for 1 minute.**

Window 0-600keV

Hot Lab

- 1. Countertop at Dose Drawing Area**
- 2. Background – outside of lab in hallway**
- 3. Dose Drawing area floor**
- 4. Hot Lab Waste Storage undercabinet area**
- 5. Entrance to Hot Lab at door**
- 6. Countertop at door end**
- 7. Closet in Hot Lab**
- 8. Stress Lab (downstairs) Entrance**
- 9. Patient table (1) in Stress Lab**
- 10. Patient table (2) in Stress Lab**
- 11. Patient floor area (1) in Stress Lab**
- 12. Patient floor area (2) in Stress Lab**
- 13. Imaging room Gamma table (1) Downstairs**

14. Imaging room floor (1) downstairs
15. Imaging room Gamma table (2) downstairs
16. Imaging room floor (2) downstairs
17. Stress treadmill area upstairs
18. Stress area floor upstairs
19. Imaging room upstairs camera area
20. Imaging room upstairs on floor near camera area
21. Control panel of upstairs imaging room equipment
22. Control panel of downstairs imaging room equipment

All wipes were below 2000 dpm. All wipe areas were also surveyed with the GM survey meter and all areas recorded less than 0.03 mR/hr.

All Sealed sources were leak tested. All leak testing was background prior to and after transport.

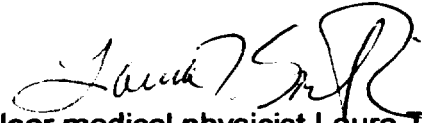
A handwritten signature in black ink, appearing to read "Laura T. Smith". The signature is written in a cursive style with a large, stylized "S" and "R" at the end.

If there are any further questions please contact survey nuclear medical physicist Laura T. Smith, MS at (586) 215-5947 or pager 313 609-2038.

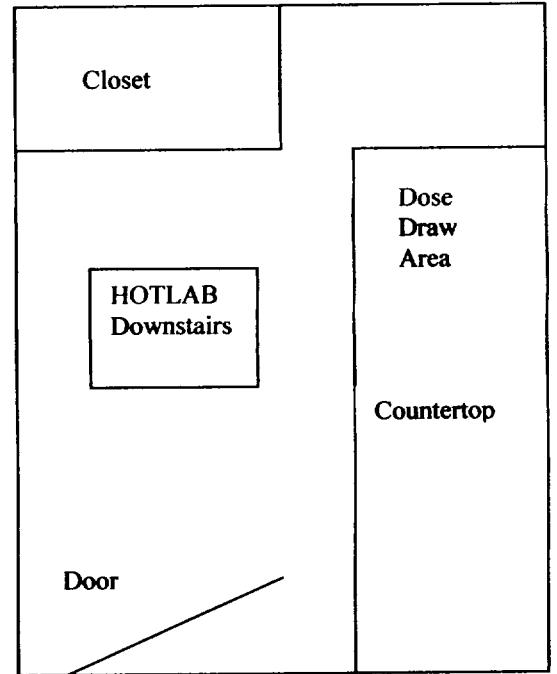
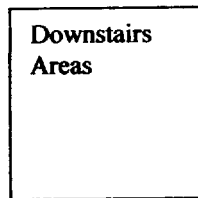

Hallway

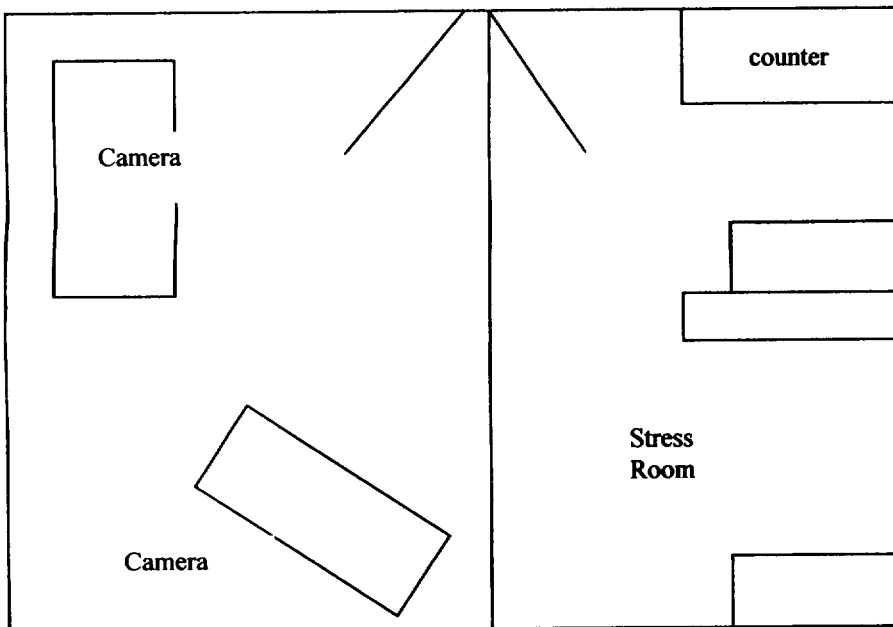

License #21-32298-01, Regional Cardiology, 2486 Nerredia, Ste E, Flint, MI 48532
3/19/2007

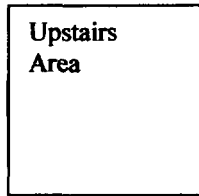
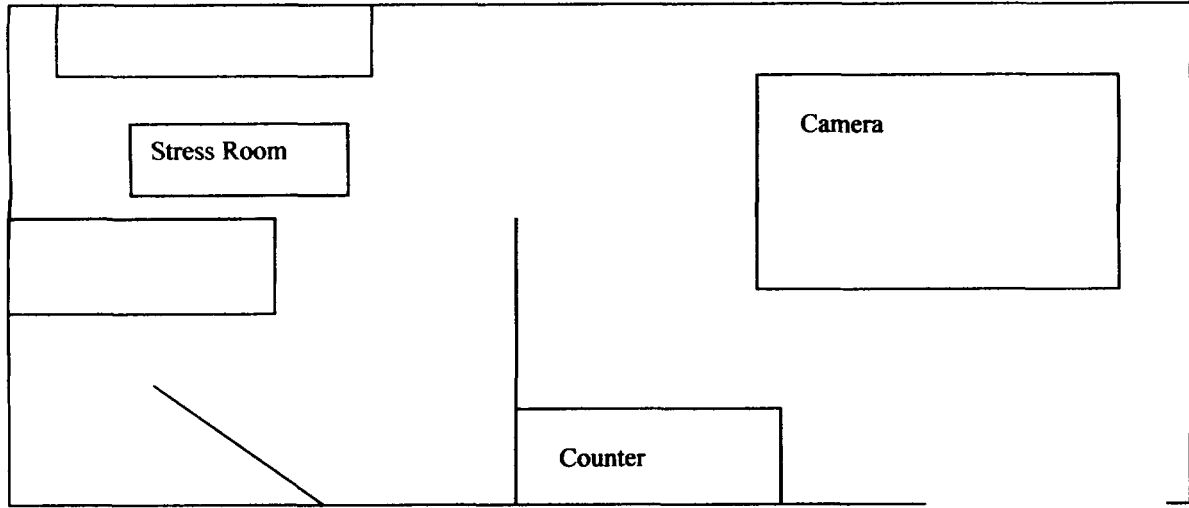



REGIONAL
CARDIOLOGY
ASSOCIATES, P.L.C.

3399 Pollock Road
Grand Blanc, MI 48439



U.S. Nuclear Regulatory Commission
Region III
Materials Licensing Branch
2443 Warrenville Road, Ste 210
Lisle, IL 60532-4352