

ROOF PLAN

- LEGEND**
- FIRE WALL
  - NUMBER INDICATES HOURS OF FIRE RESISTANCE
  - FIRE WALL I.D. NUMBER

FIRE AREAS

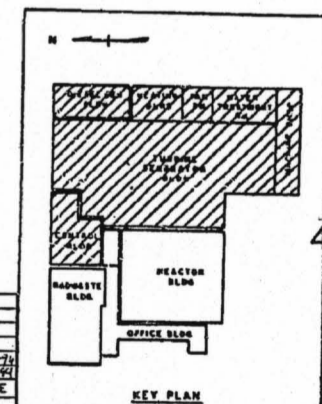

REV. NO.	DATE	DESCRIPTION	BY	CHKD.	APP.
1	11/17/68	...	...	...	...
2	12/11/68	...	...	...	...
3	1/15/69	...	...	...	...
4	2/10/69	...	...	...	...
5	3/10/69	...	...	...	...
6	4/10/69	...	...	...	...
7	5/10/69	...	...	...	...
8	6/10/69	...	...	...	...
9	7/10/69	...	...	...	...
10	8/10/69	...	...	...	...
11	9/10/69	...	...	...	...
12	10/10/69	...	...	...	...
13	11/10/69	...	...	...	...
14	12/10/69	...	...	...	...
15	1/10/70	...	...	...	...
16	2/10/70	...	...	...	...
17	3/10/70	...	...	...	...

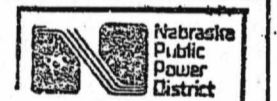

FOR PREVIOUS REVISIONS SEE SUPERSEDED CARDS.

INFORMATION ONLY

454003642

BURNS AND ROE, INC.  
ENGINEERS AND CONSTRUCTORS  
NEW YORK, N. Y.

GENERAL ARRANGEMENT  
TURBINE BUILDING  
OPERATING FLOOR PLAN

CONSUMERS PUBLIC POWER DISTRICT  
COOPER NUCLEAR STATION

DRAWN BY: J.S.D.  
CHECKED BY: J.S.D.  
DATE: 11/17/68  
W.O. 2520  
DWG. 2052

REV. NO.	DATE	DESCRIPTION	BY	CHKD.	APP.
1	11/17/68	REVISED WATER TREATMENT AREA AND STAIRWAYS	...	...	...
2	12/11/68	REVISED CONTROL ROOM AREA, STAIRWAYS, INSTRUMENT SUPPORT CENTER, ADDED VENTILATION EQUIPMENT	...	...	...
3	1/15/69	REVISED CONTROL ROOM; INSTRUMENT SUPPORT CENTER; STAIRWAYS	...	...	...
4	2/10/69	ADDED STRONG ACID PUMP IN WATER TREATMENT AREA	...	...	...
5	3/10/69	ADDED INSTRUMENT SUPPORT CENTER	...	...	...
6	4/10/69	ADDED LOCATION OF INSTRUMENT SUPPORT CENTER	...	...	...
7	5/10/69	ADDED LOCATION OF INSTRUMENT SUPPORT CENTER	...	...	...
8	6/10/69	ADDED LOCATION OF INSTRUMENT SUPPORT CENTER	...	...	...
9	7/10/69	ADDED LOCATION OF INSTRUMENT SUPPORT CENTER	...	...	...
10	8/10/69	ADDED LOCATION OF INSTRUMENT SUPPORT CENTER	...	...	...
11	9/10/69	ADDED LOCATION OF INSTRUMENT SUPPORT CENTER	...	...	...
12	10/10/69	ADDED LOCATION OF INSTRUMENT SUPPORT CENTER	...	...	...
13	11/10/69	ADDED LOCATION OF INSTRUMENT SUPPORT CENTER	...	...	...
14	12/10/69	ADDED LOCATION OF INSTRUMENT SUPPORT CENTER	...	...	...
15	1/10/70	ADDED LOCATION OF INSTRUMENT SUPPORT CENTER	...	...	...
16	2/10/70	ADDED LOCATION OF INSTRUMENT SUPPORT CENTER	...	...	...
17	3/10/70	ADDED LOCATION OF INSTRUMENT SUPPORT CENTER	...	...	...

D-16